

NORTH CREEK COMMERCE CENTER

A 240,601-square foot,
brand new flex / industrial
park for lease in Bothell

18712 BOTHELL-EVERETT HWY, BOTHELL, WA



DEVELOPED BY

 PANATTONI®

REPRESENTED BY

 JSH | PROPERTIES, INC.

 **km** Kidder
Mathews

North Creek Commerce Center is a 240,601 SF, class-A flex/industrial park with direct access to Bothell-Everett Highway.

Delivery Q1 2025

2.7 stalls / 1,000 SF parking ratio

32' clear height

Dock / Grade level loading

130' dedicated truck court

Heavy power

Easy access to I-405 and I-5

Call agents for lease rates

TAKE VIRTUAL TOUR

BLDG C
115,400 SF

BLDG B
104,610 SF

BLDG A
22,971 SF

425 FITNESS

BURGERMASTER
Original Montreal Style

BOTHELL-EVERETT HWY



Perfectly connected with easy access to major freeways and interstate highways

2.5 MI
TO I-405

3.4 MI
TO I-5

4.7 MI
TO SR-9

MUKILTEO



PAINE FIELD AIRPORT



8 MIN TO I-5

NORTH CREEK
COMMERCE CTR

9 MIN TO SR-9



MONROE



LYNNWOOD

6 MIN TO I-405



MALTBY



BOTHELL

WOODINVILLE

SHORELINE

KIRKLAND



SITE PLAN

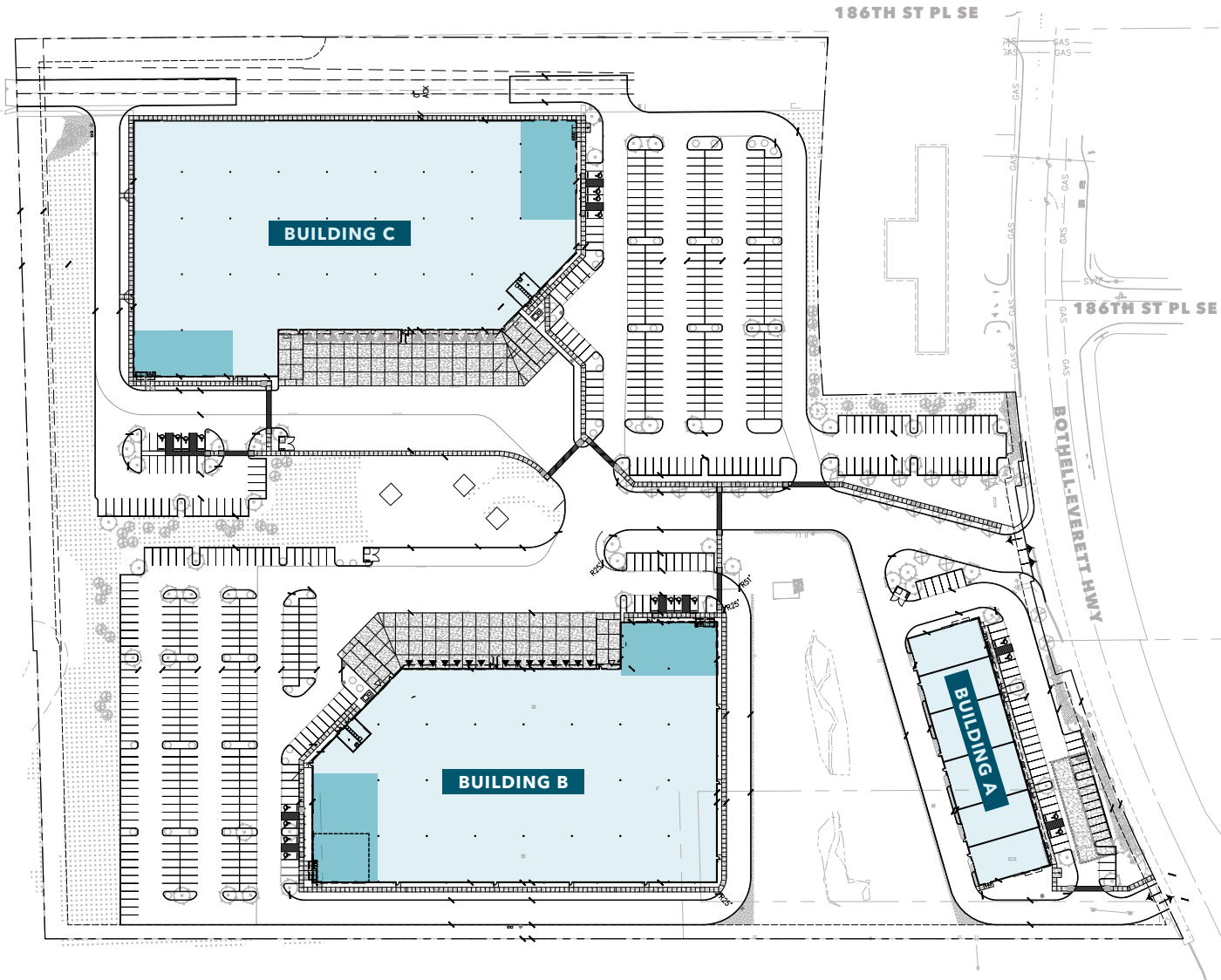

▲ DRIVE-IN DOORS

△ DOCK-HIGH DOORS



BUILDING C

113,020

TOTAL SF

BTS

OFFICE SPACE

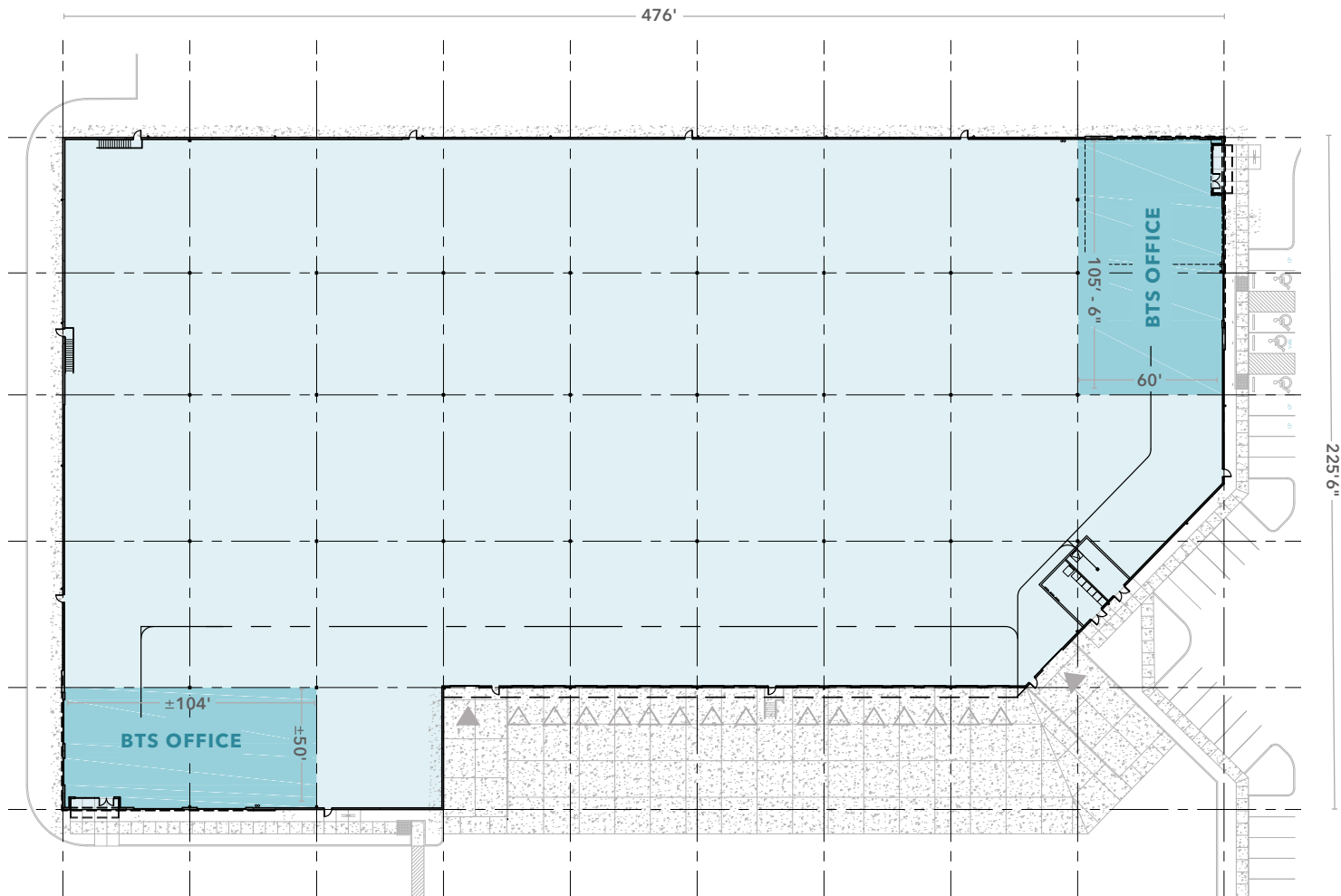

▲ DRIVE-IN DOORS ▲ DOCK-HIGH DOORS ■ WAREHOUSE ■ OFFICE



BUILDING B

104,610
TOTAL SF

BTS
OFFICE SPACE

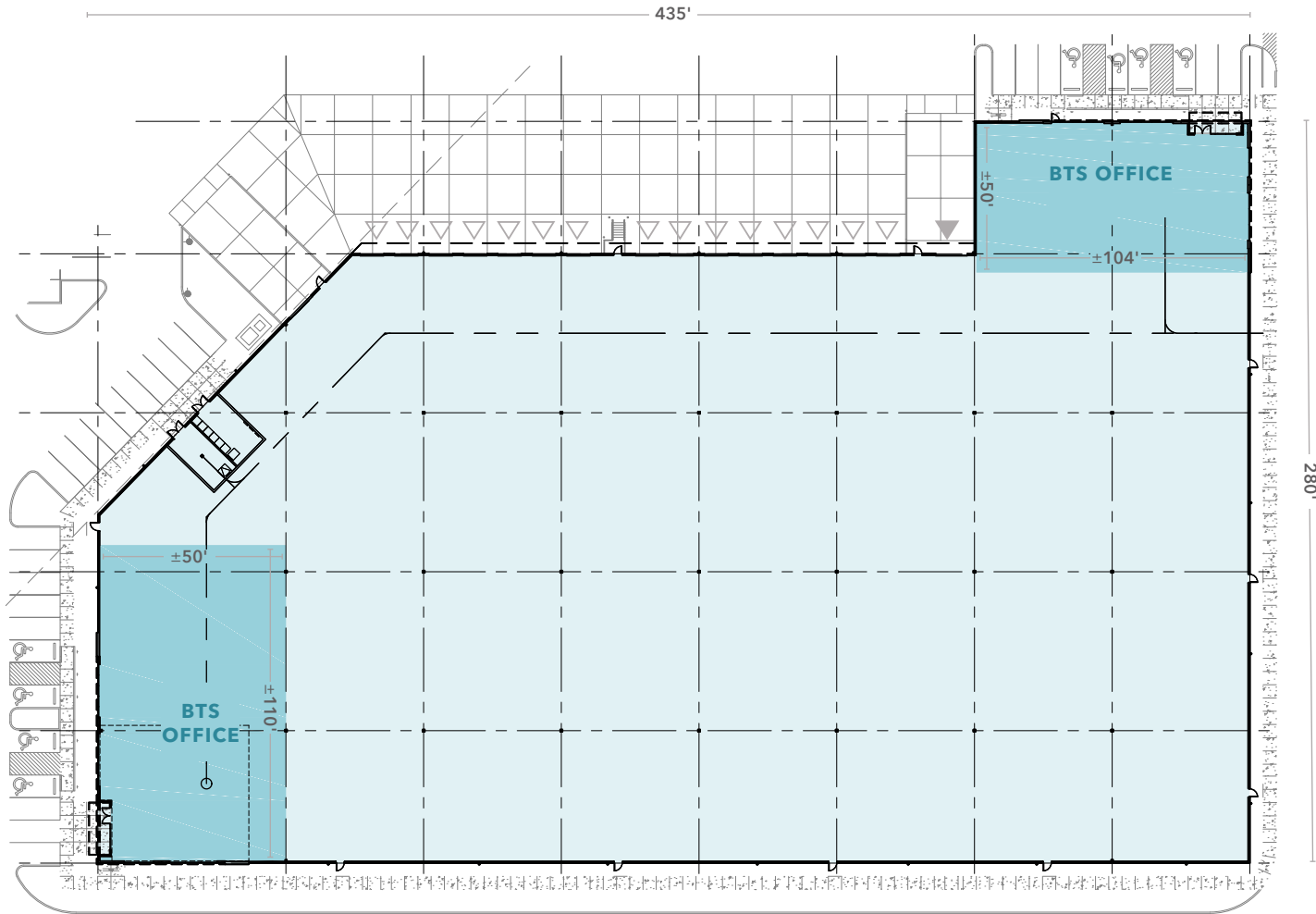

▲ DRIVE-IN DOORS △ DOCK-HIGH DOORS ■ WAREHOUSE ■ OFFICE



BUILDING A

22,971

TOTAL SF

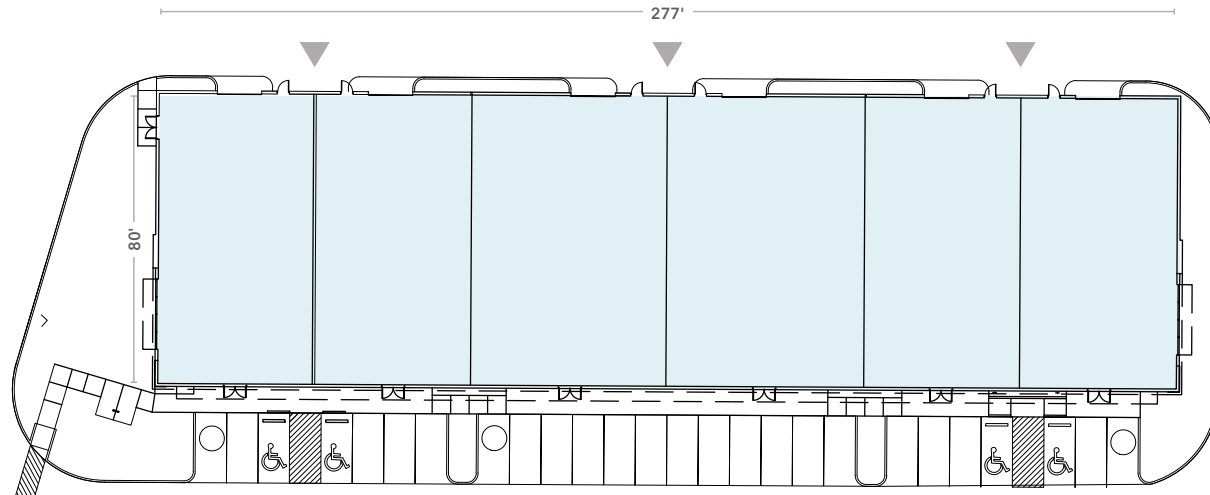

Elevations



NORTH CREEK COMMERCE CENTER

NORTHCREEKCOMMERCE.COM



For leasing information contact

ZACH VALL-SPINOSA

Kidder Mathews
425.450.1115
zach.vallspinosa@kidder.com

ERNIE VELTON

JSH Properties
425.283.5471
erniev@jshproperties.com

REESE VELTON

JSH Properties
425.283.5484
reesev@jshproperties.com

DEVELOPED BY

 PANATTONI®

REPRESENTED BY

 JSH | PROPERTIES, INC.

 **Kidder
Mathews**

This information supplied herein is from sources we deem reliable. It is provided without any representation, warranty, or guarantee, expressed or implied as to its accuracy. Prospective Buyer or Tenant should conduct an independent investigation and verification of all matters deemed to be material, including, but not limited to, statements of income and expenses. Consult your attorney, accountant, or other professional advisor.