



**WEST SEATTLE**  
INDUSTRIAL / FLEX SPACE

1,233 SF AVAILABLE MARCH 1ST, 2025

\$16.00/SF + NNN \$4.67/SF

# W MARGINAL WAY BUSINESS PARK

4101 WEST MARGINAL WAY, SEATTLE, WA 98106

RODNEY SWIFT  
425.283.5480  
rods@jshproperties.com

 JSH | PROPERTIES, INC.

THE INFORMATION CONTAINED HEREIN HAS BEEN GIVEN TO US BY SOURCES WE DEEM RELIABLE. WE HAVE NO REASON TO DOUBT ITS ACCURACY, BUT WE DO NOT GUARANTEE IT. ALL INFORMATION SHOULD BE VERIFIED PRIOR TO PURCHASE OR LEASE.

425.455.0500 | JSHPROPERTIES.COM

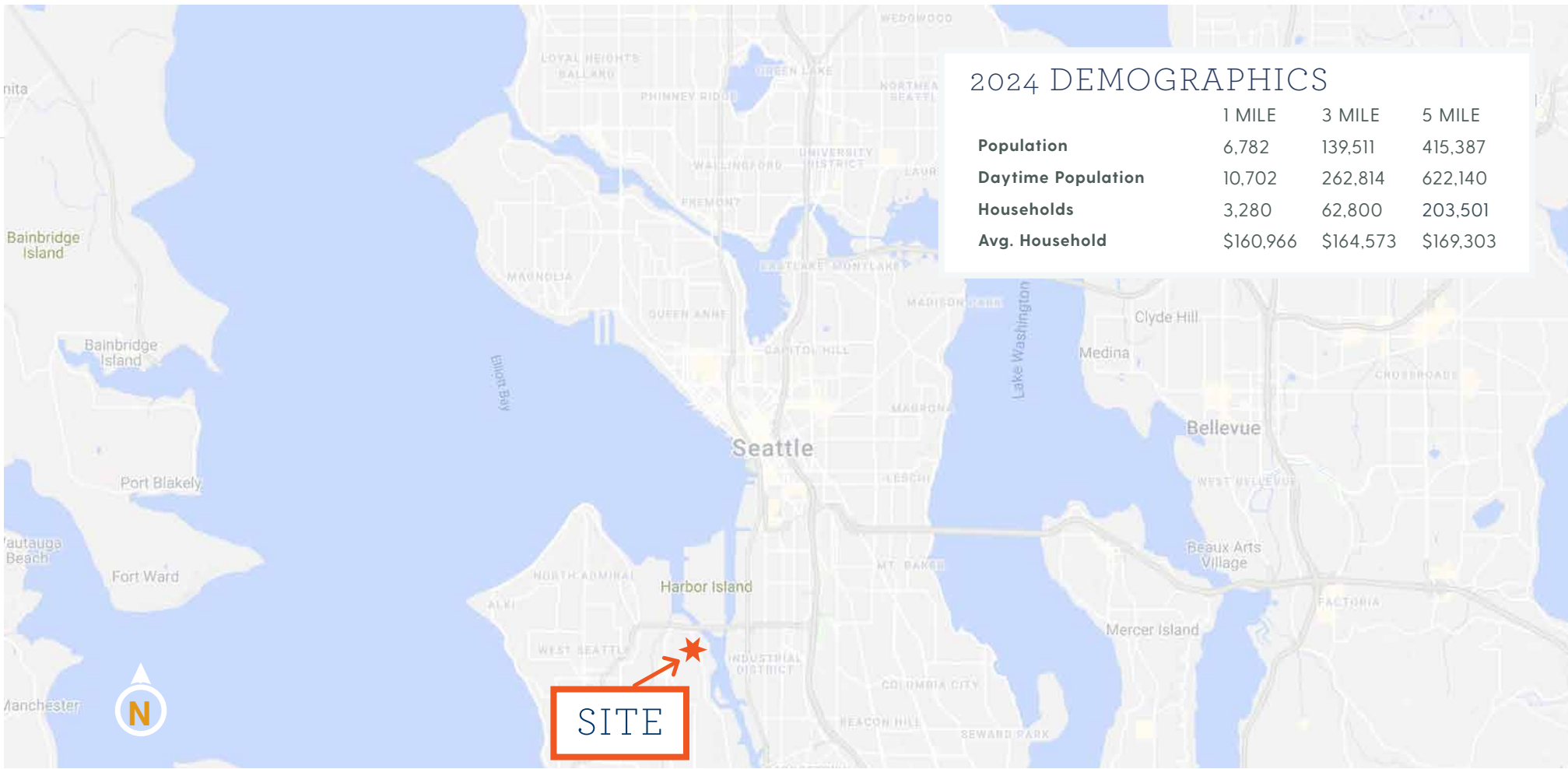

# WEST MARGINAL WAY BUSINESS PARK

- Two-building industrial park with parking located within the center.
- Each unit has an office, restroom and full height rolling doors.
- Close to West Seattle Golf Course, South Seattle Community College

AVAILABLE	SF	RATE	NNN
SUITE A4 (March 1, 2025)	1,233	\$16/sf	\$4.67/sf

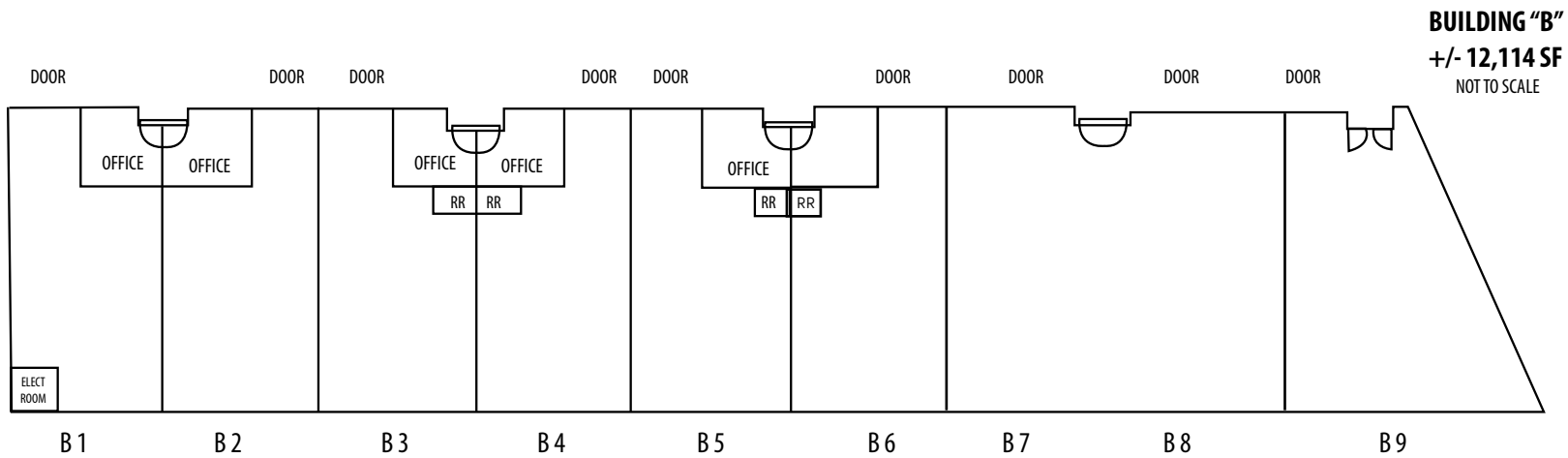
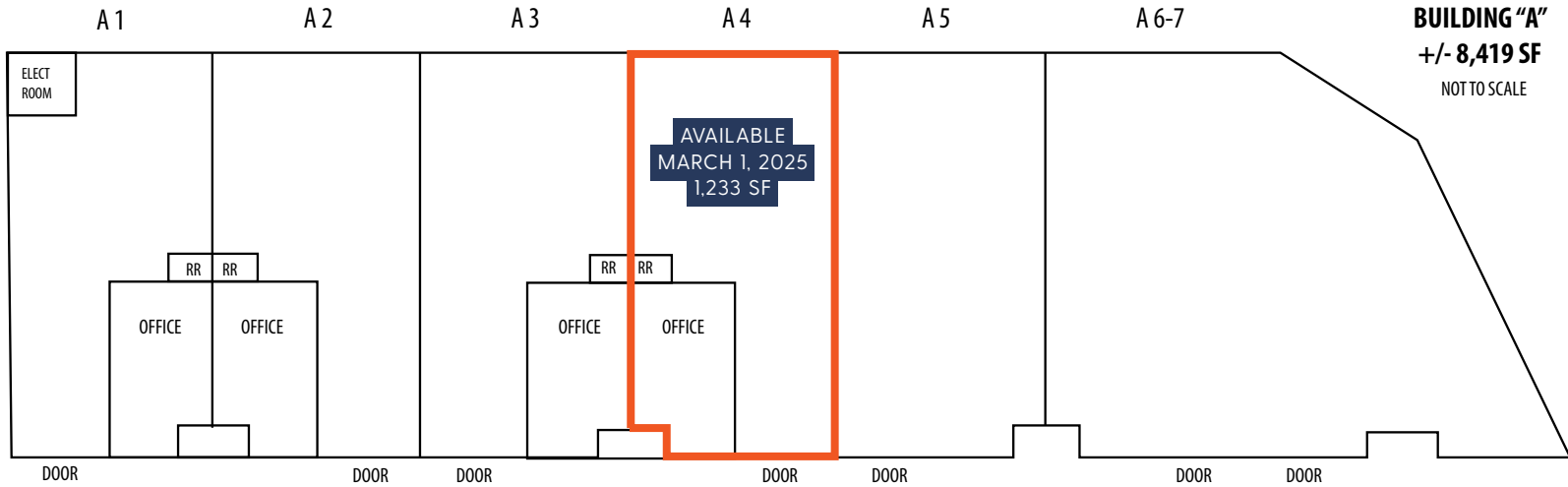

WEST MARGINAL WAY